

TV/MONITOR SELF-STANDING

Instruction Manual
Bedienungsanleitung
Mode d'emploi

PARTS

[dimensions in mm / different scales]
No extra or spare parts listed!

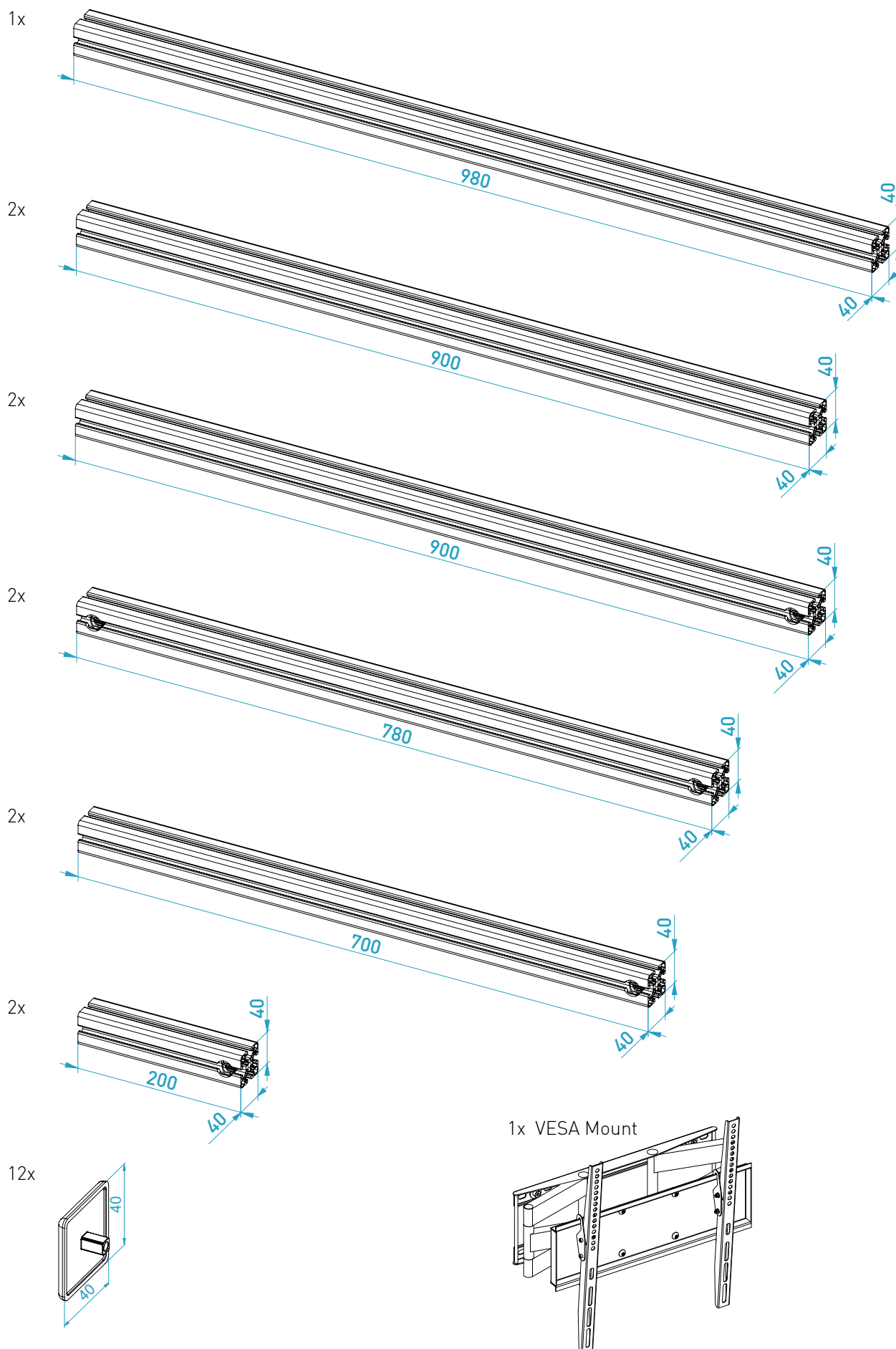

BAG 1

20x

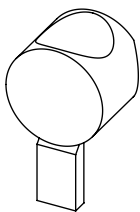

20x

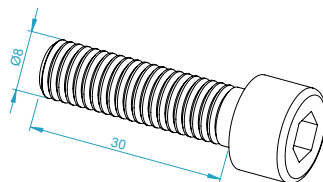

20x

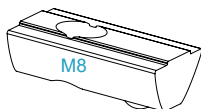

BAG 2

6x

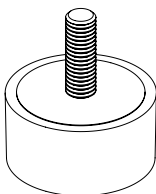

6x

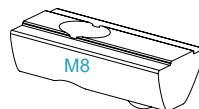

6x

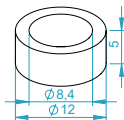

6x

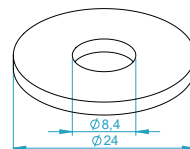

6x

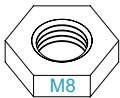

BAG 3

8x

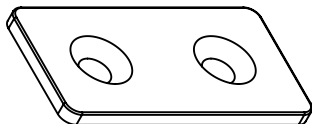

16x

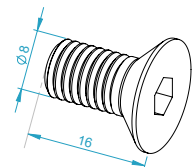

black

16x

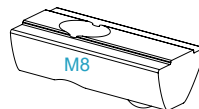

BAG 4

4x

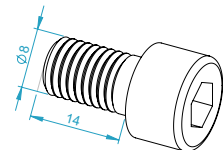

4x

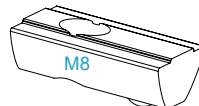

4x

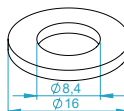

ASSEMBLY

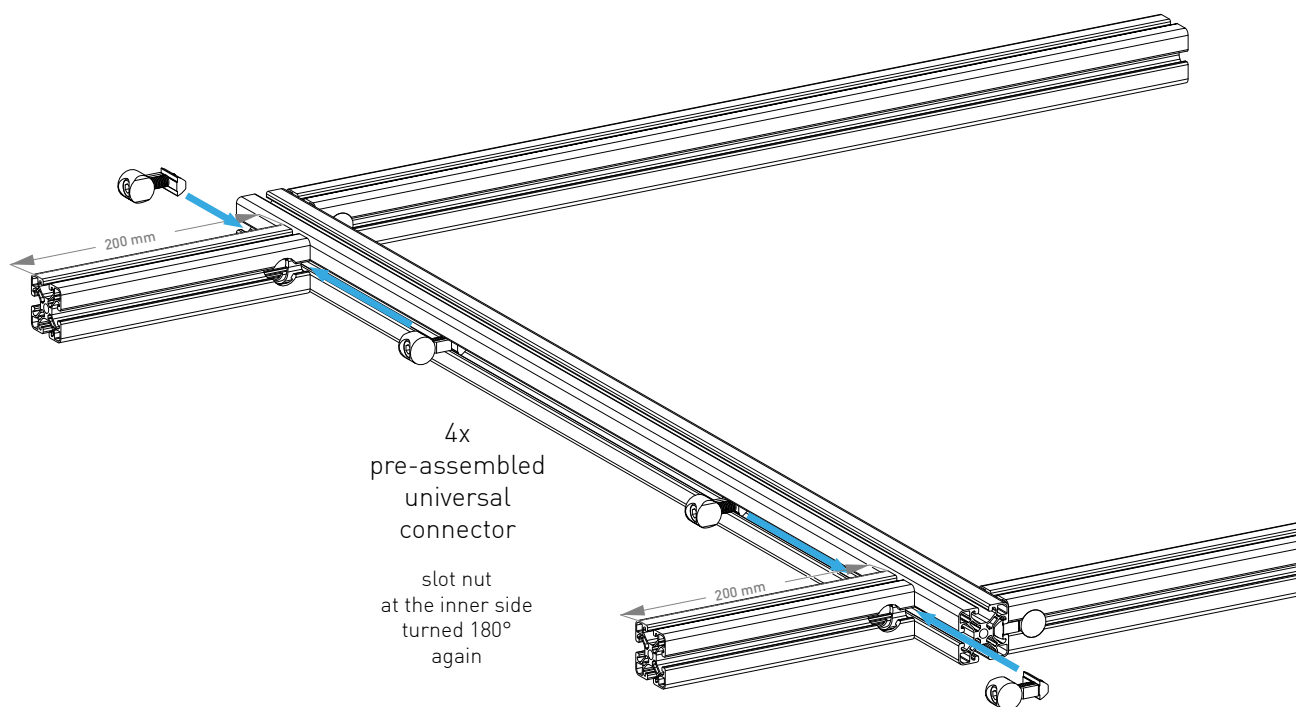
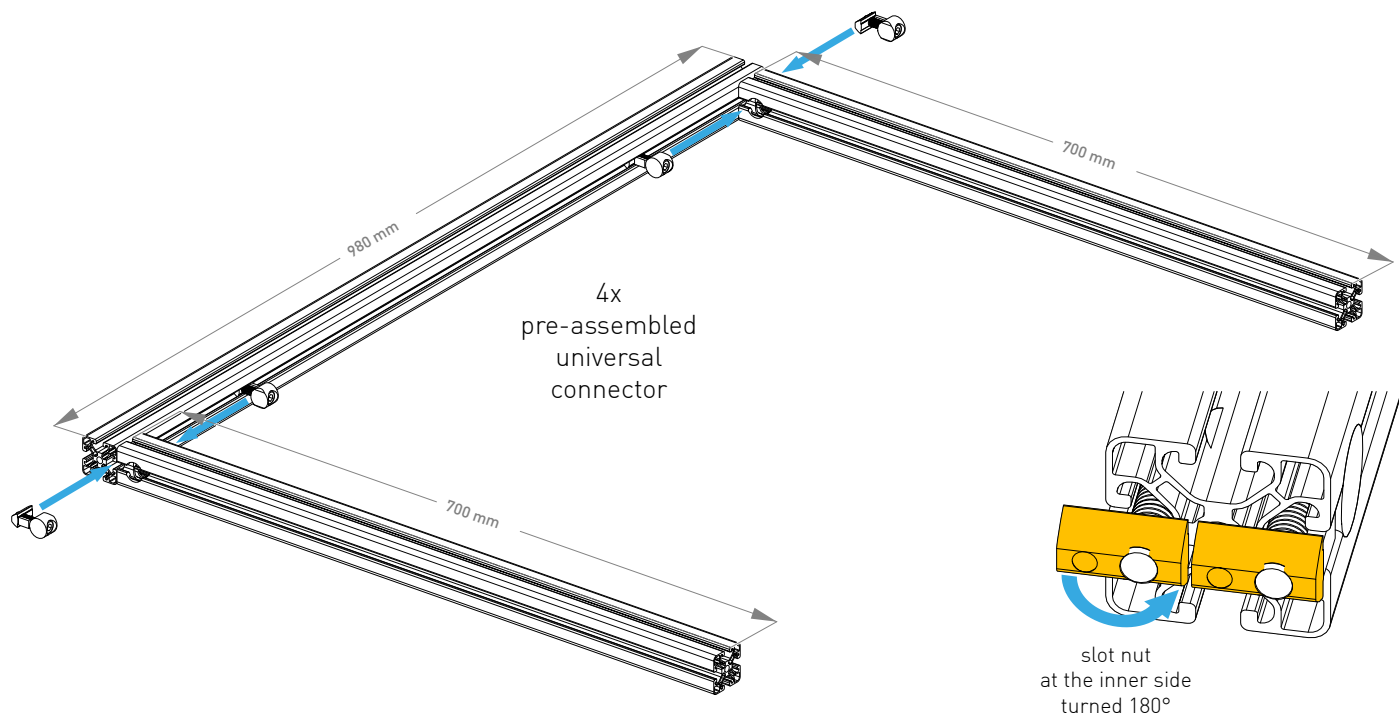
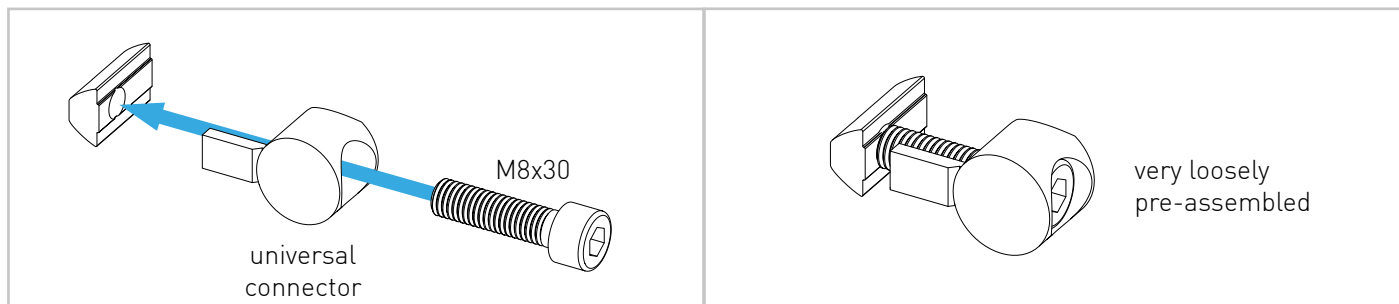

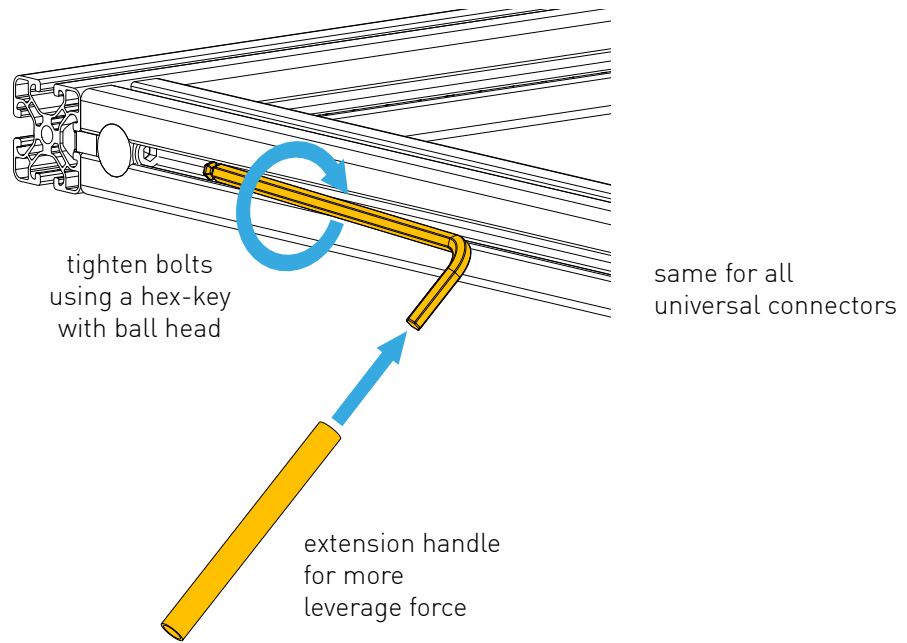

Mounting the feet

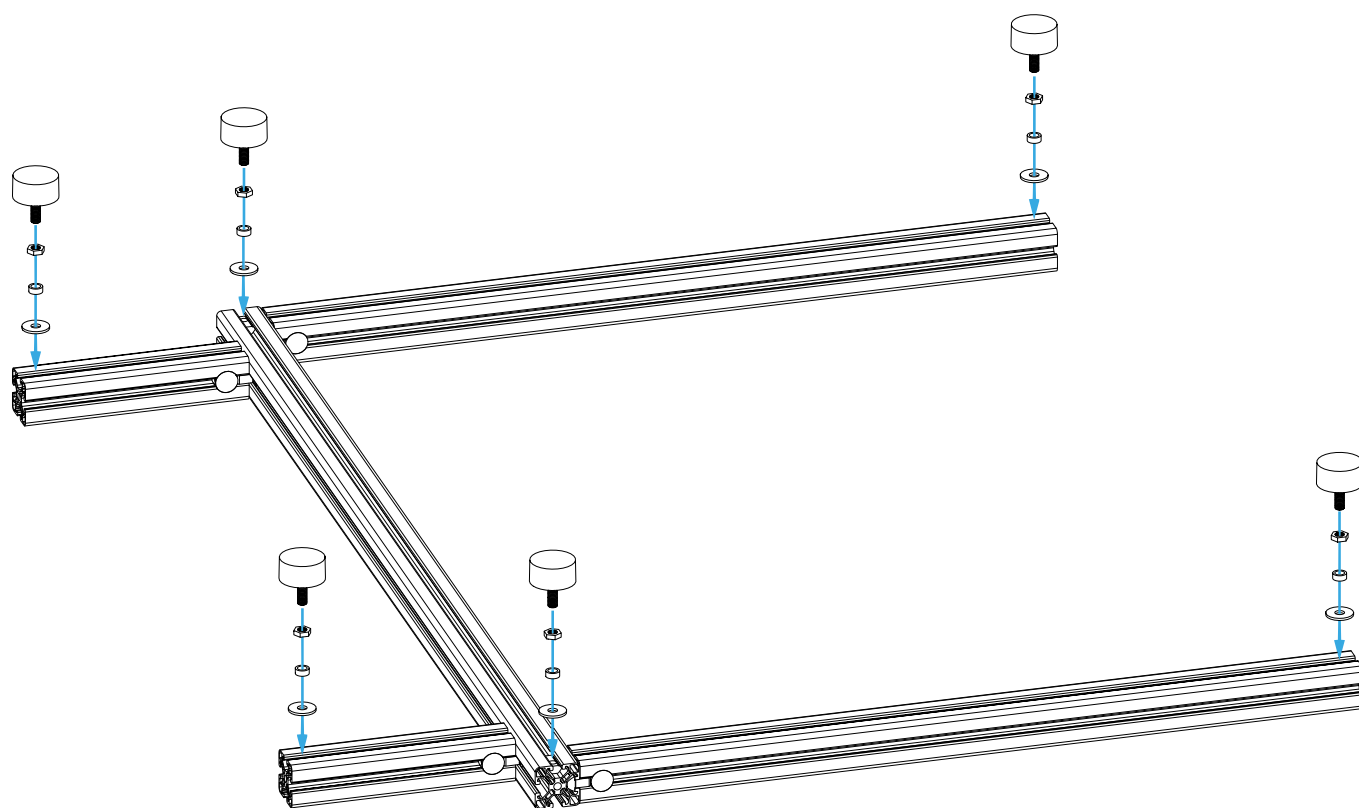
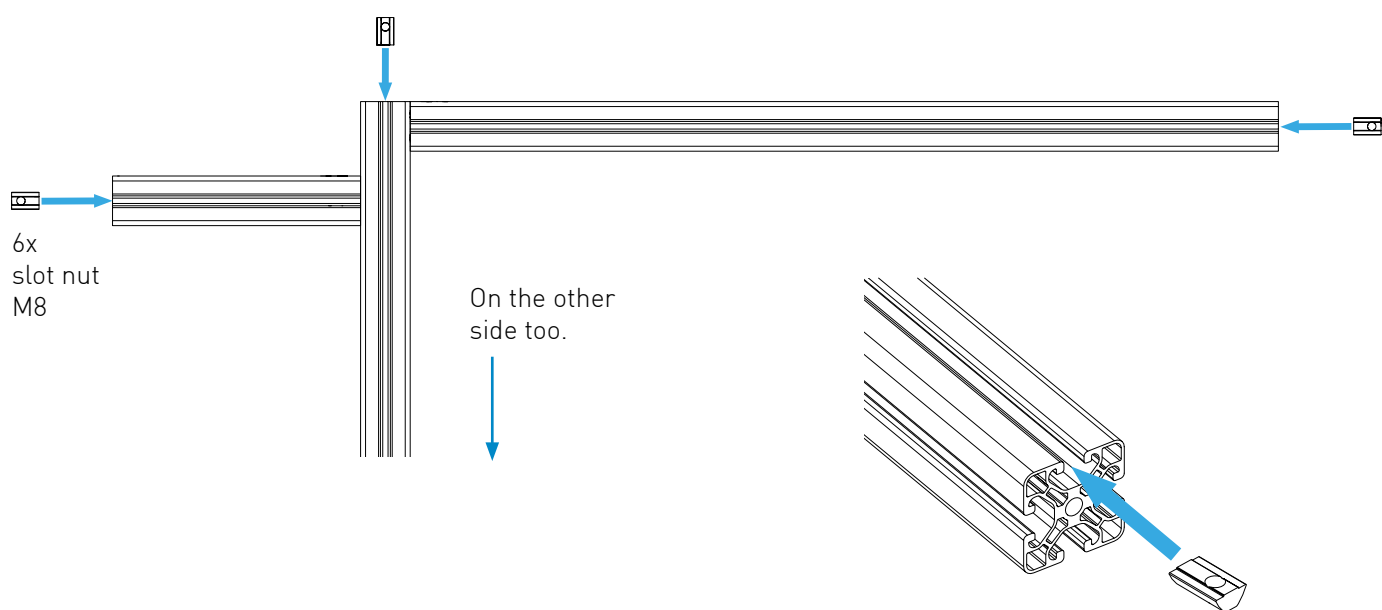

detail next page

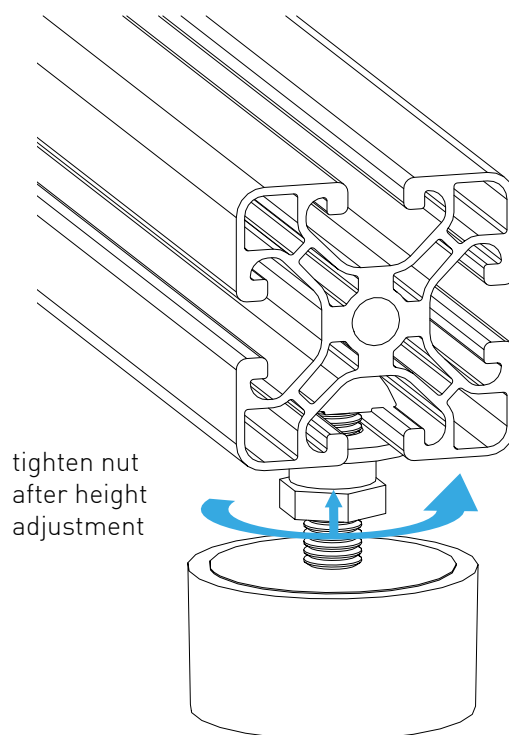
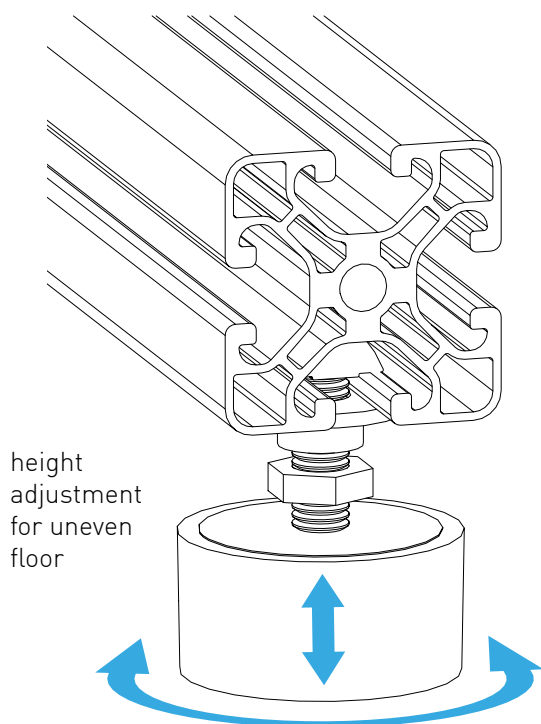
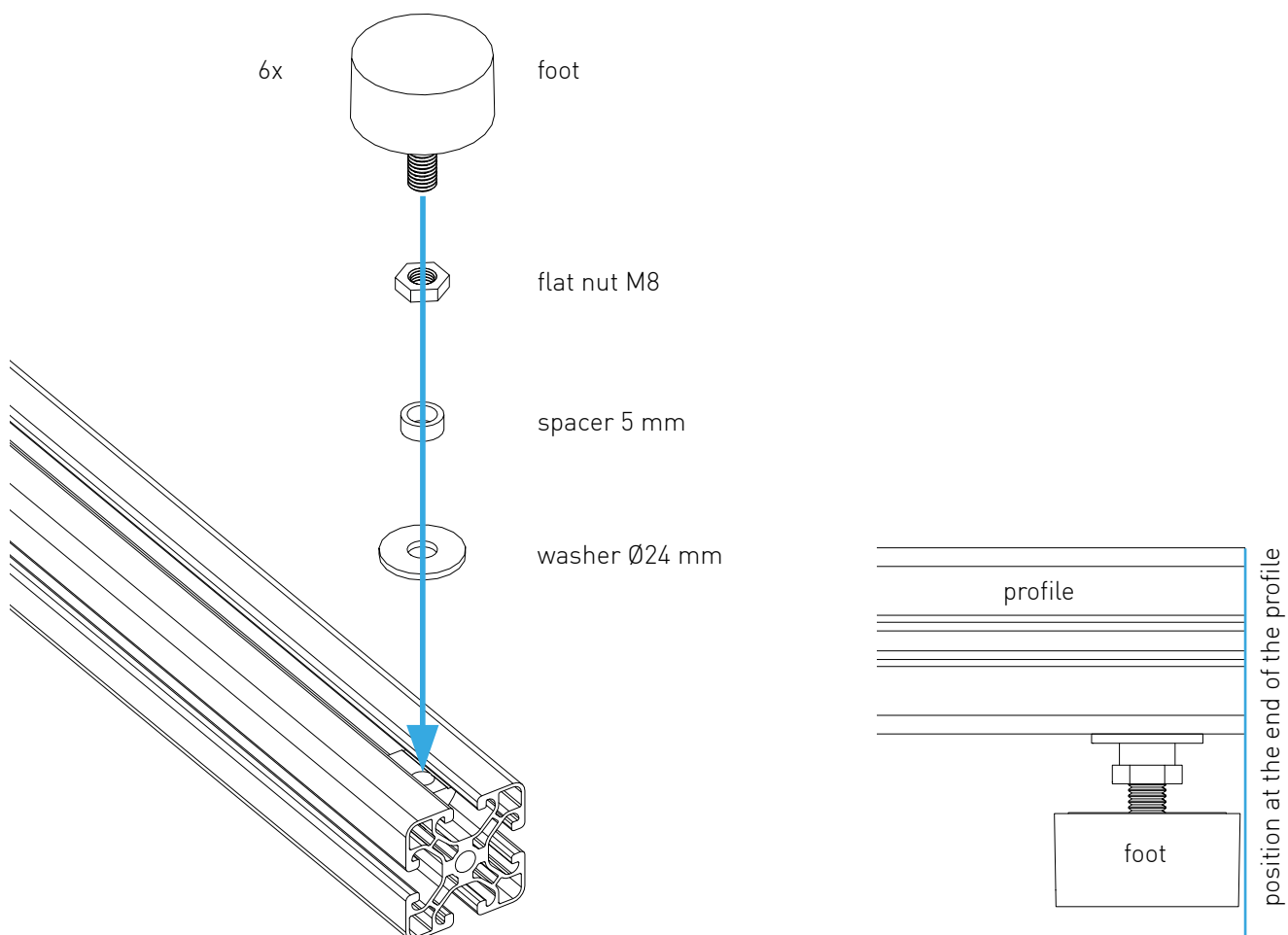

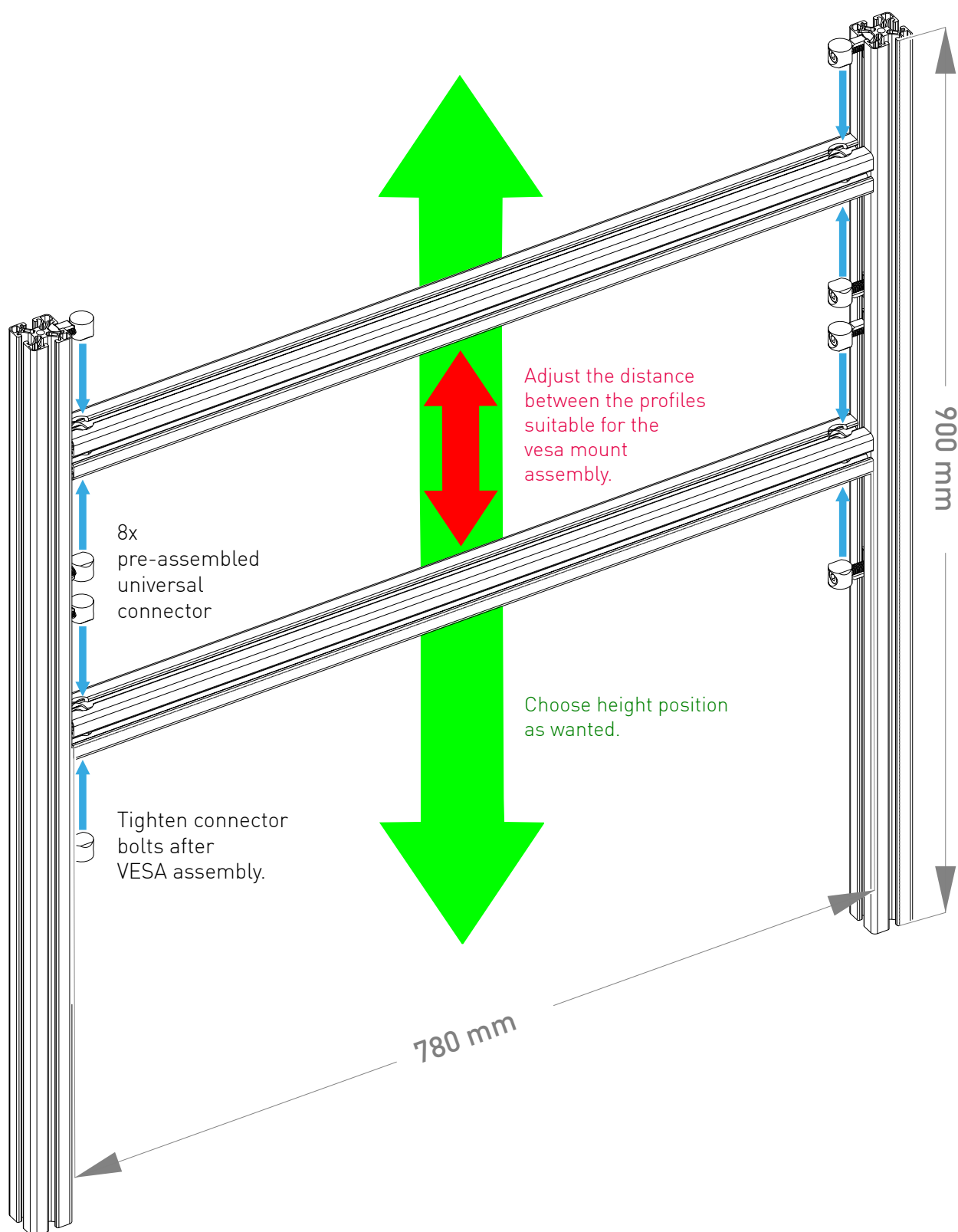

Assembling the VESA mount

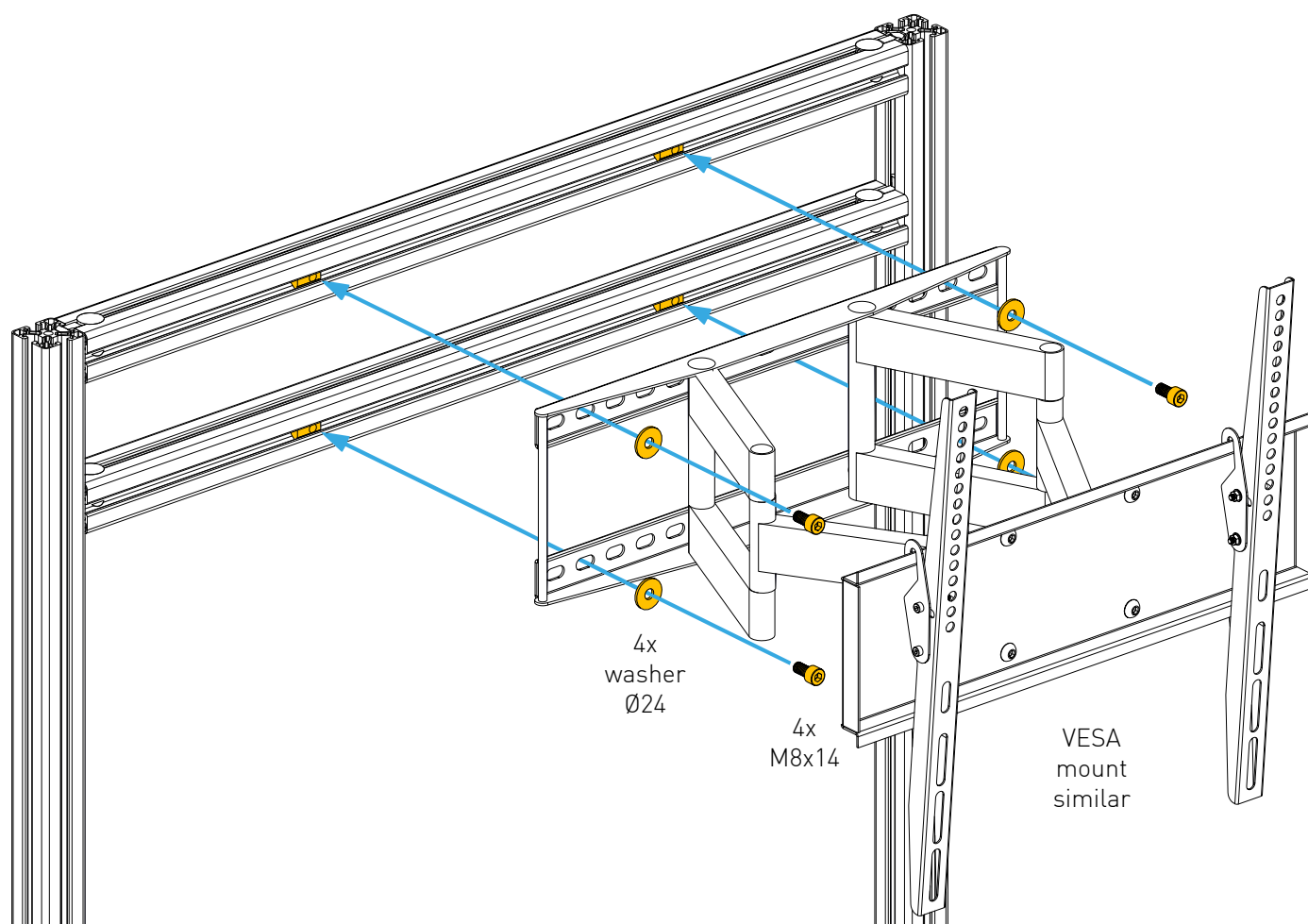
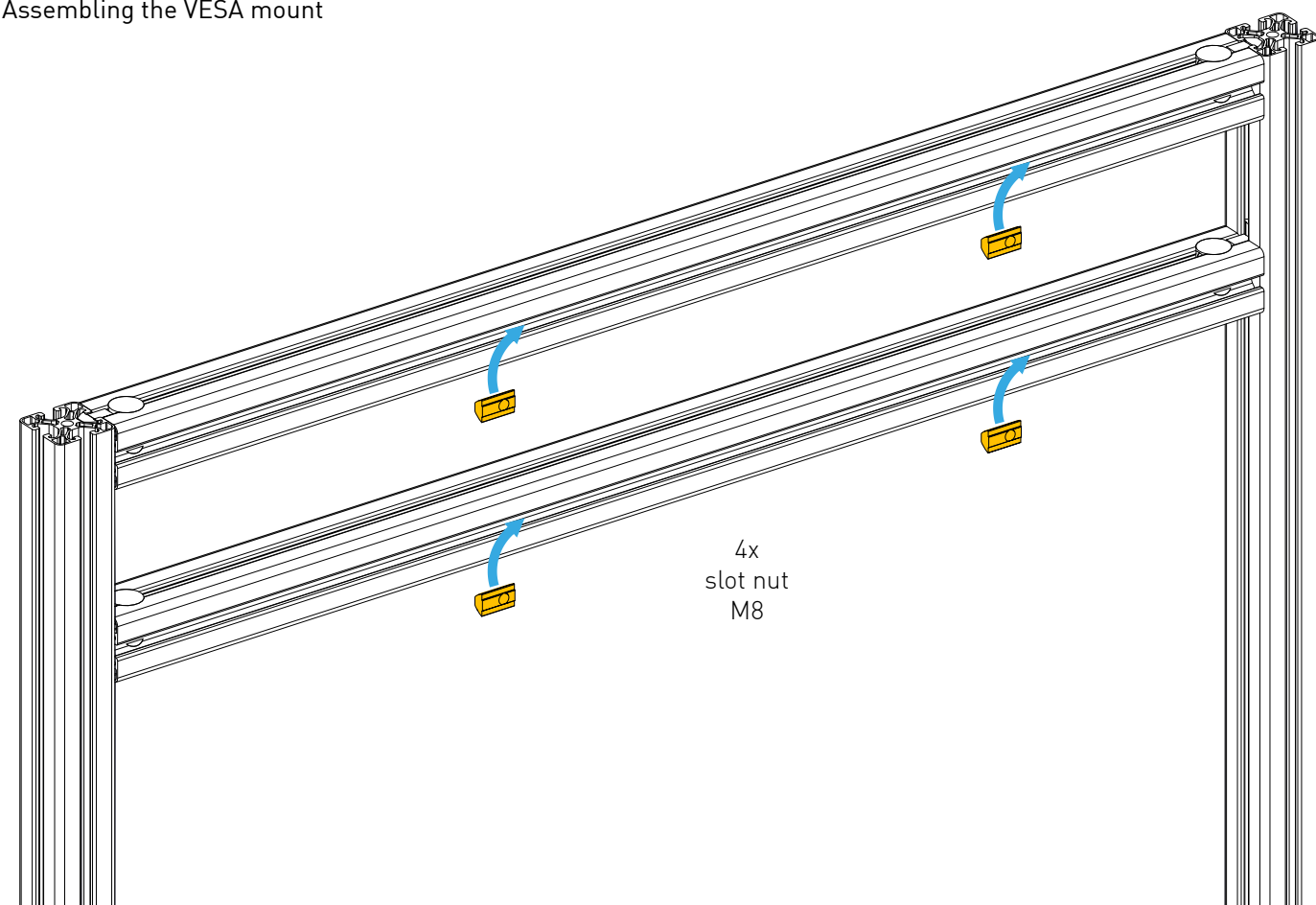

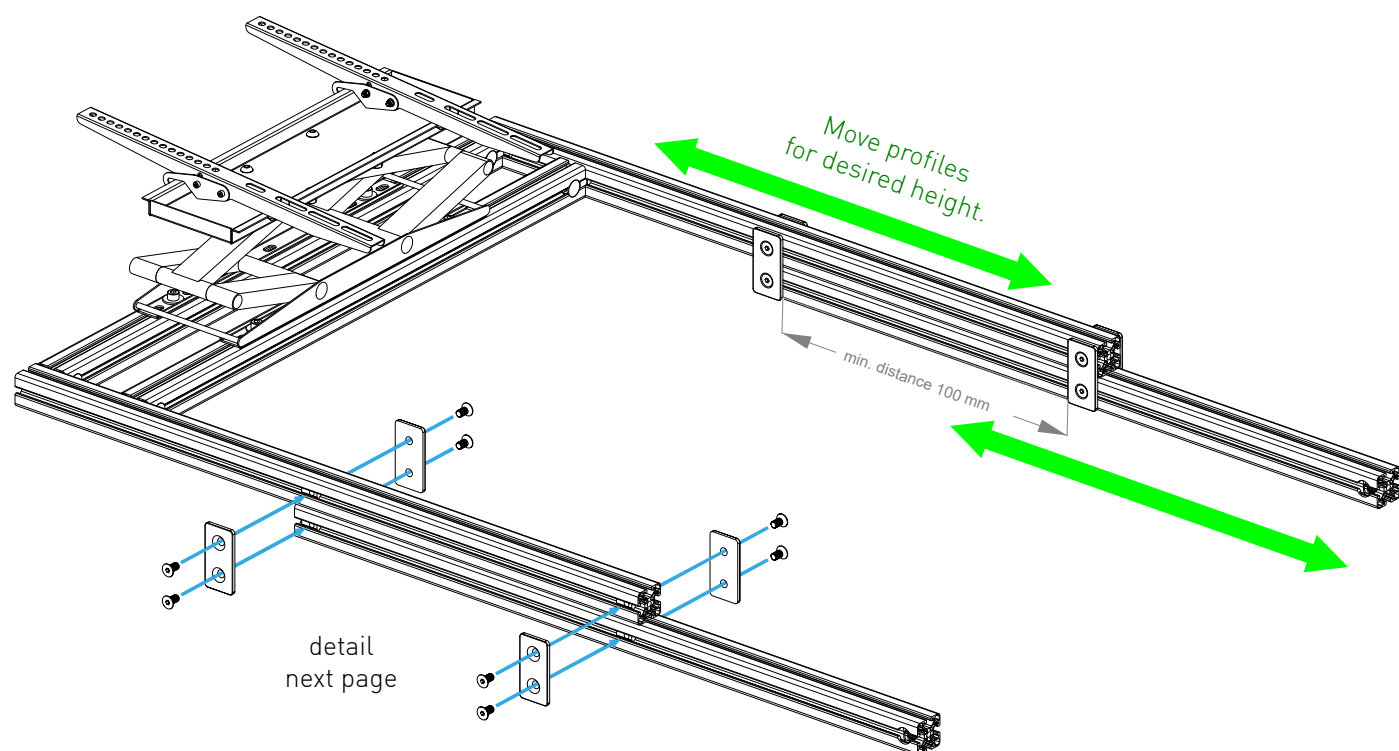
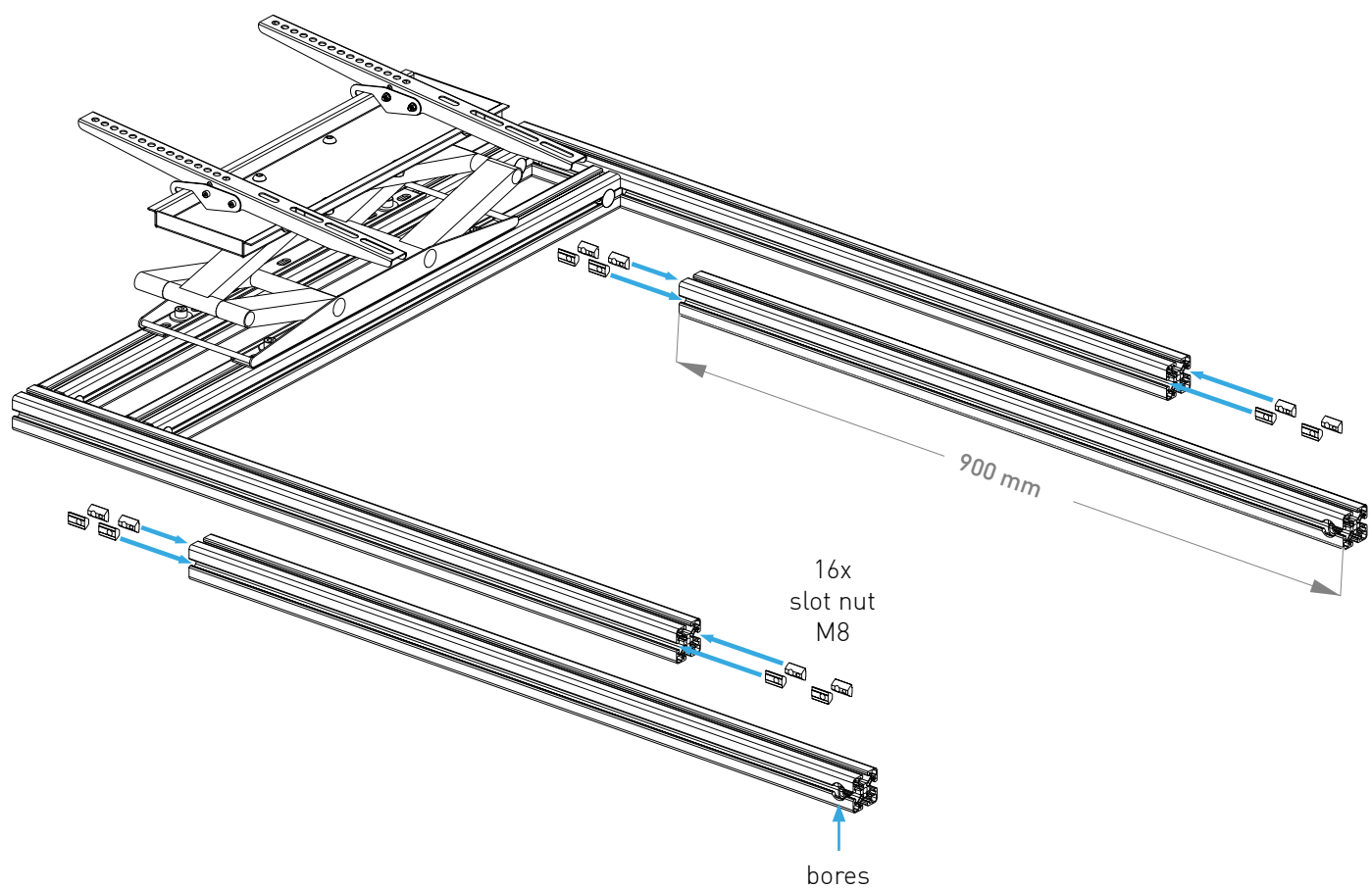

For both sides
of the frame

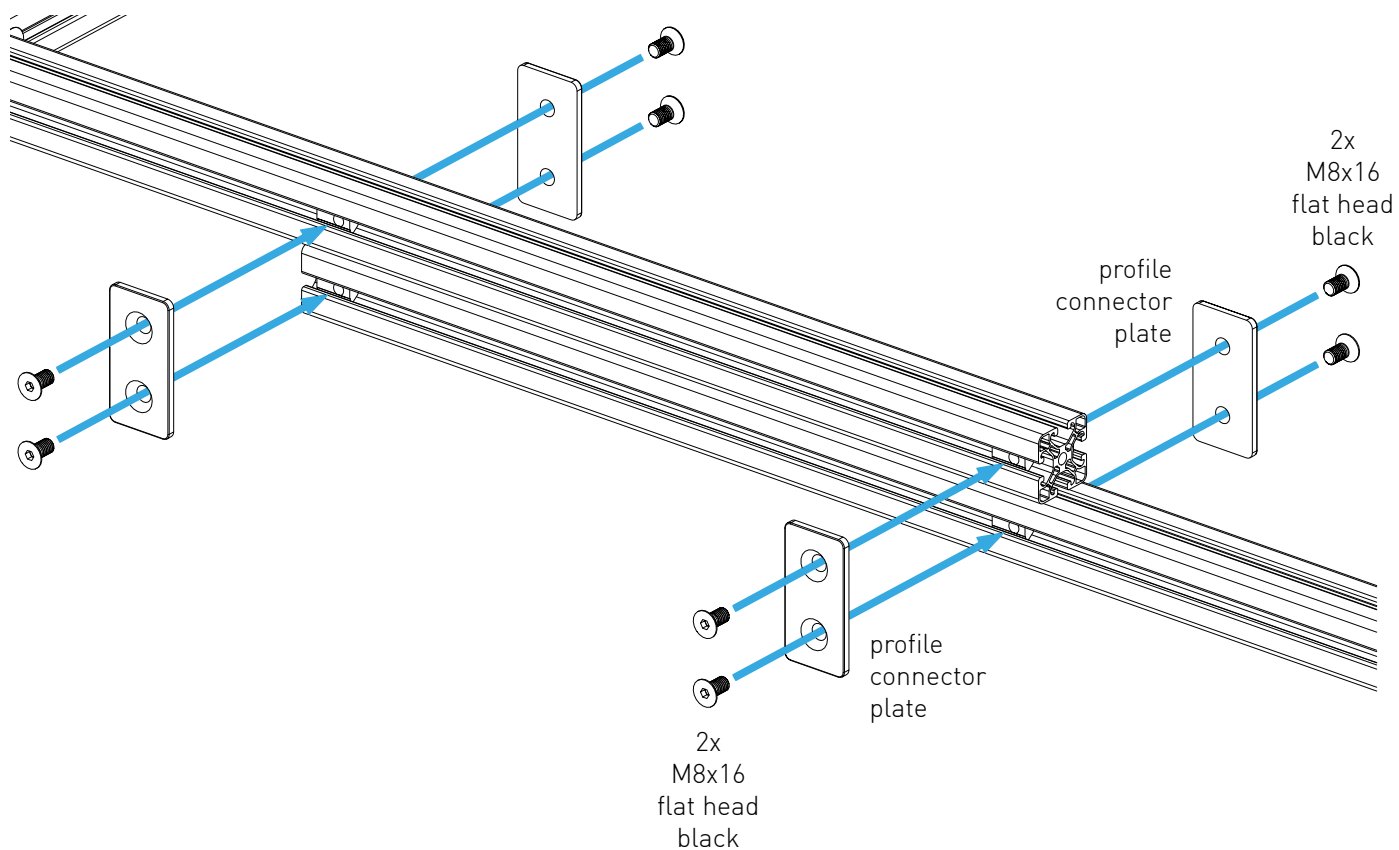

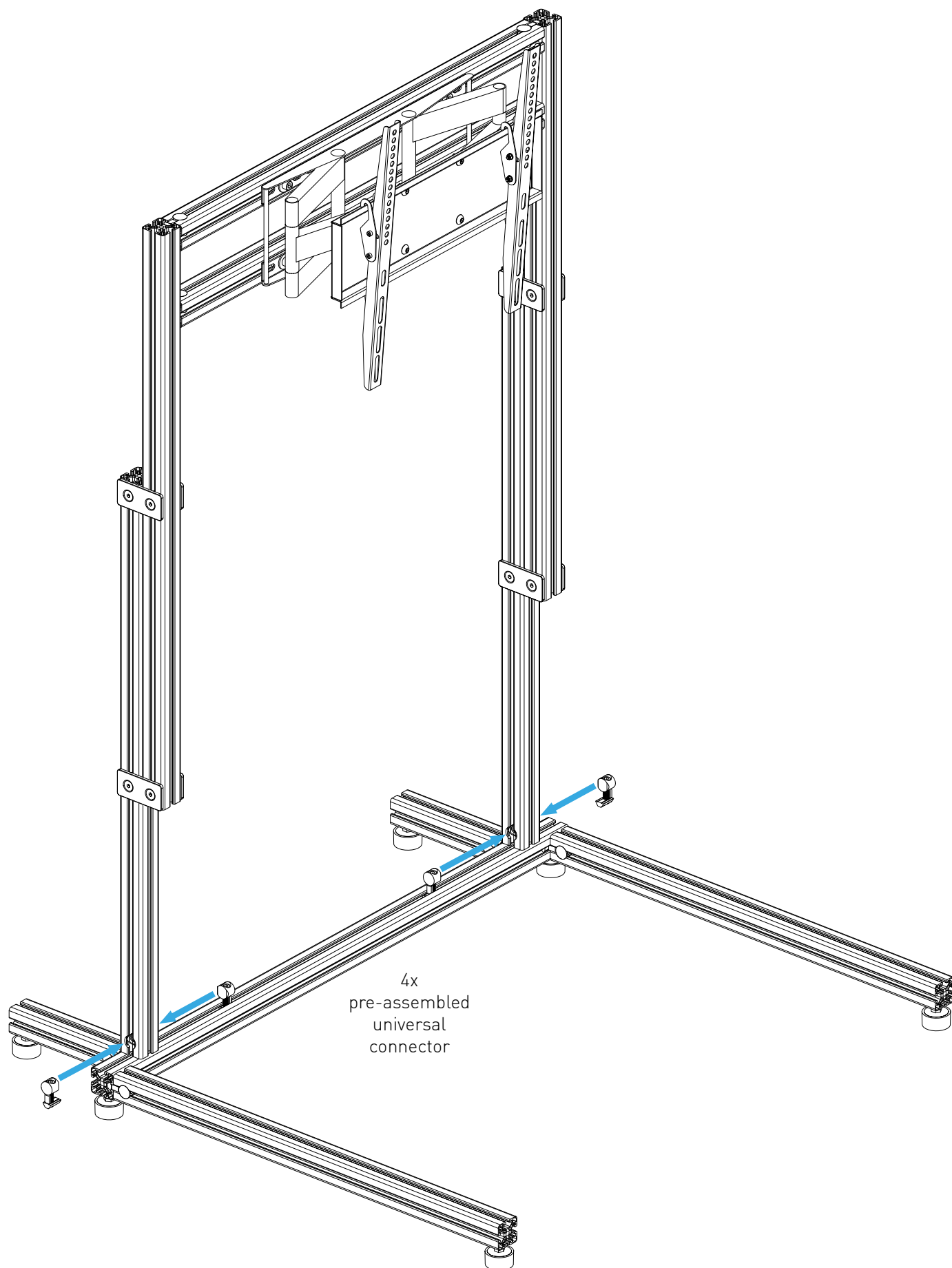

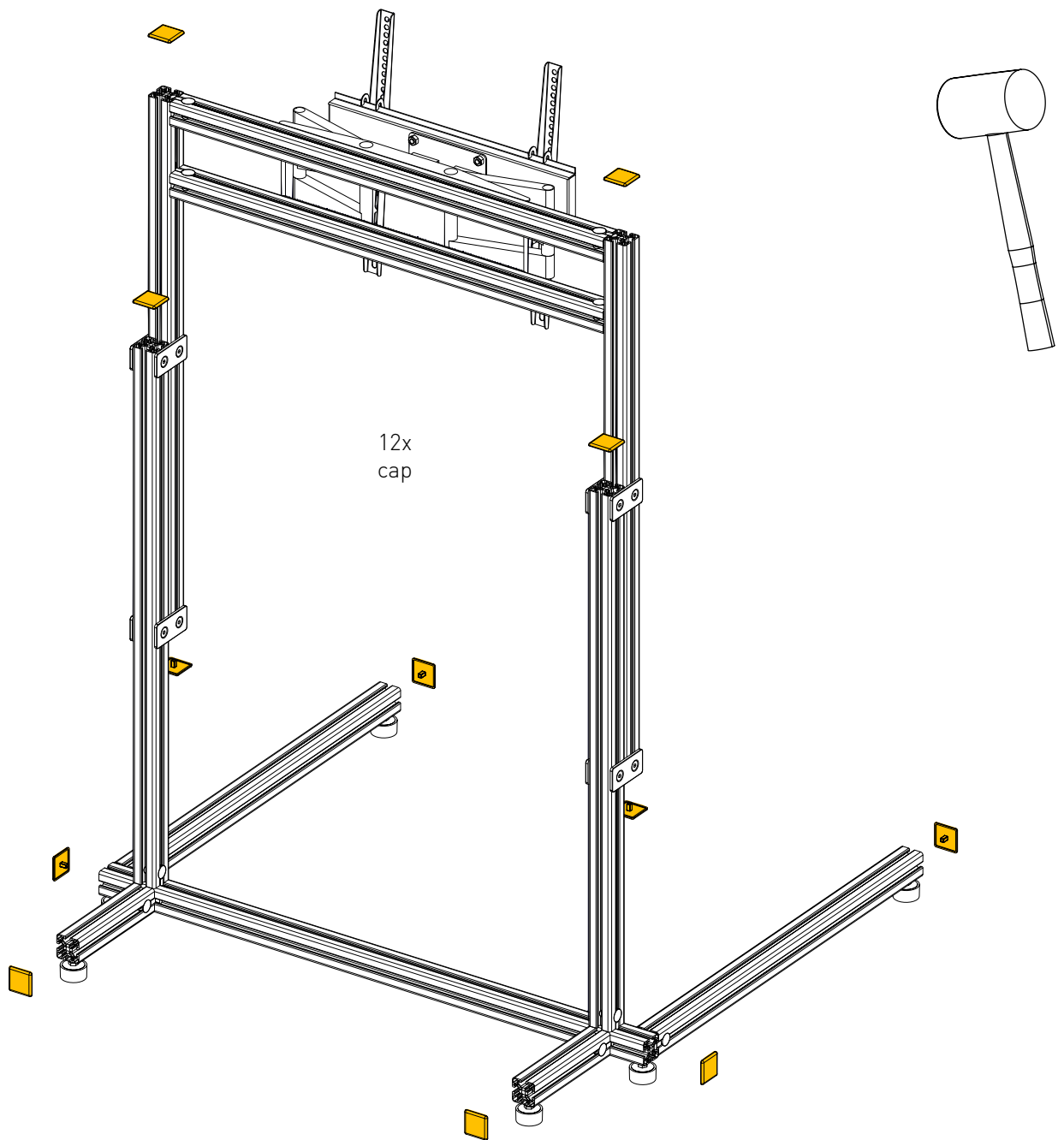

detail:

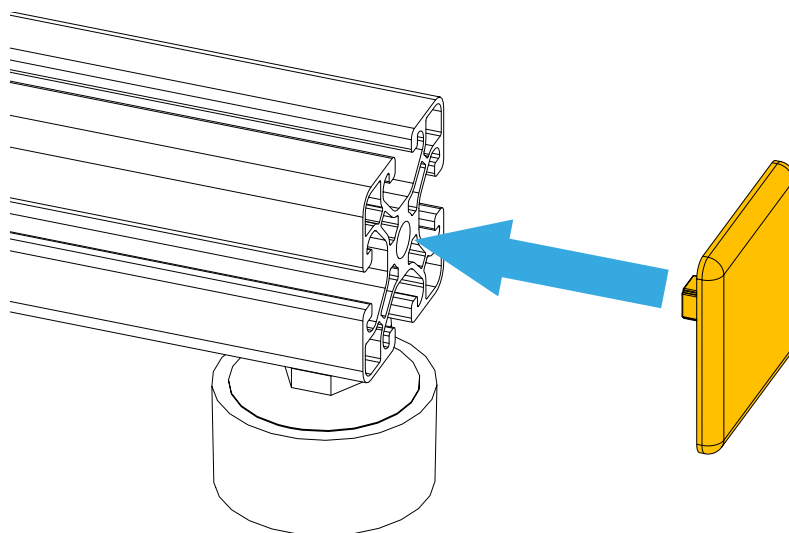

Optional with TV/Monitor Triple Extension

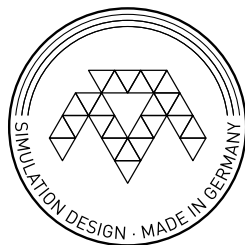
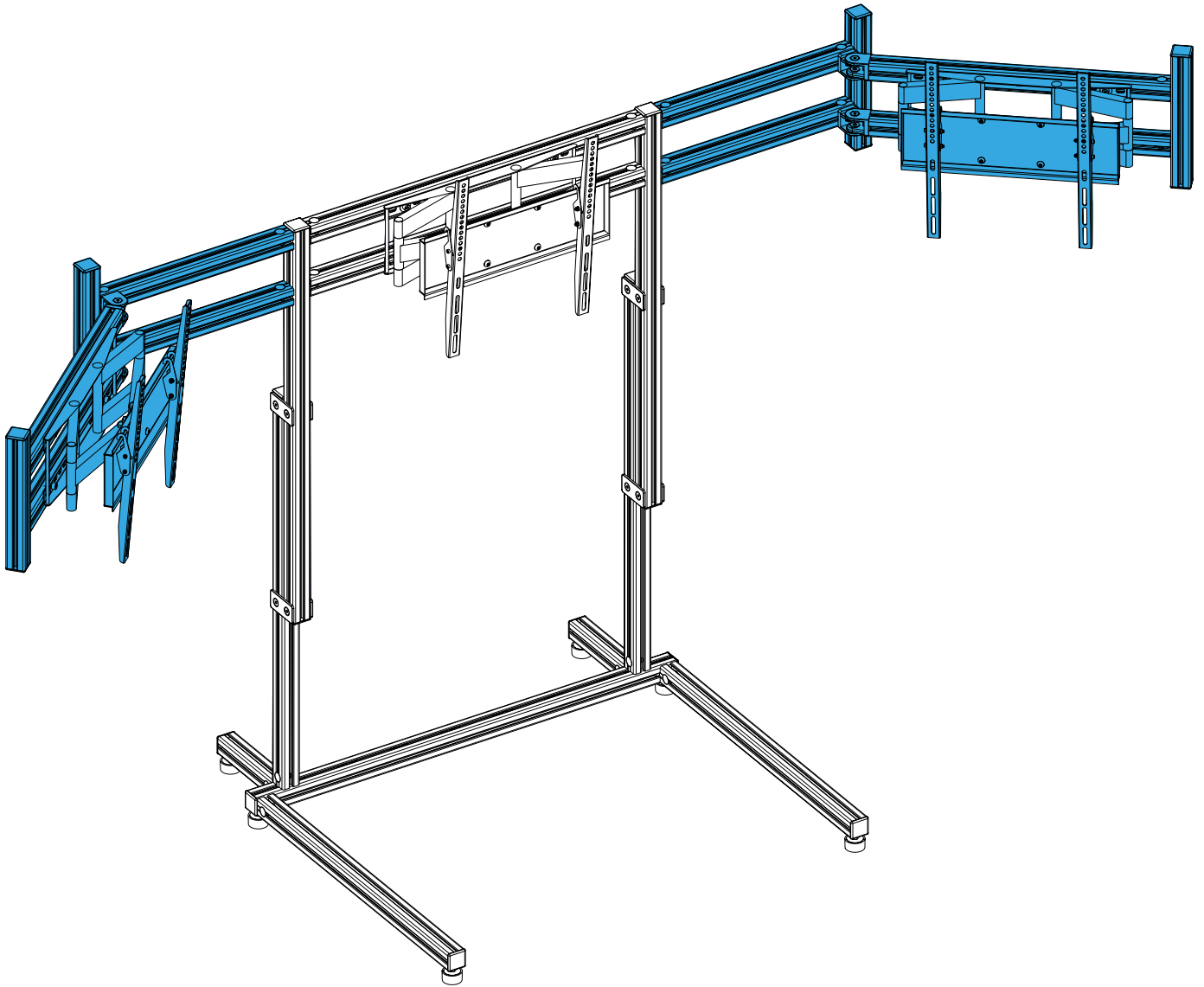

22-04-2022